



Midwest Fasteners
 450 Richard St.
 Miamisburg, OH 45342
Website: www.midwestfasteners.com
sales@midwestfasteners.com

Toll Free: (800) 852-8352
Phone: (937) 866-0463
Fax: (937) 866-4174
Email:

[All Categories](#) > [Weld Studs](#) > [Arc Weld Studs](#) > [Rectangular Arc Weld Studs With Hole](#)

RECTANGULAR ARC WELD STUDS WITH HOLE

W	Min. L	D	X	Ferrule Code
3/8	7/8	0.203	5/16	R375
5/8	1"	0.312	5/16	R625

Materials

Low Carbon Steel

C - 0.23% max. P - 0.04% max.

Mn - 0.90% max. S - 0.05% max.

Stainless Steel

AISI grade - 302/304/305 std.

Other grades available upon request.

Mechanical Properties

Low Carbon Steel

Tensile - 60,000 psi (min.)

Yield - 50,000 psi (min.)

Elongation - 20% (in 2 inches)

Stainless Steel

Values for various grades available upon request.

Arc
Weld
Studs

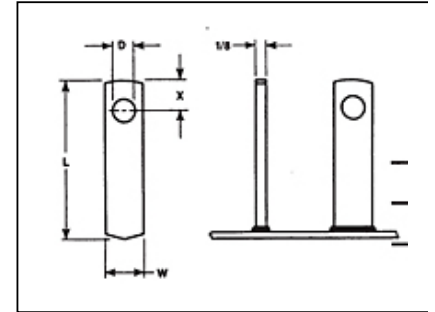

Plating

Low Carbon Steel

Plating is not standard.

Copper, nickel, and zinc available upon customer request.

Stainless Steel

Does not apply to Stainless.

Ferrules

Ferrules are component parts of studs. Not sold separately.

Please click the [Request Information](#) button to configure your Rectangular Arc Weld Studs With Hole.

[less](#)

Ferrules

Ferrules

Code	B	D	E	M	Part No.
R375	0.505	0.625	0.156	0.390	092 0020 08

R625 0.921 0.500 0.188 0.438 092 0020 11